

- Map 1 SR 1900 - Chandler Mill Rd
Resurface Bridge # 254
- Map 2 SR 1901 - Spring Water Rd
- Map 3 SR 1902 - Dibrell Rd
NO Pavement on Bridge #106, Bridge to be replaced Tie down the AST Retreatment at the project limits and skip the length of the project.
- Map 4 SR 1903 - Sigmon Rd
- Map 5 SR 1904 - Bradley Rd
- Map 6 SR 1906 - Bark Rd
- Map 7 SR 1908 - Lillard Rd
Resurface Bridge # 101
- Map 8 SR 1910 - Dickerson Rd
- Map 9 SR 1911 - Newton Rd
- Map 10 SR 1912 - Stephens Rd
- Map 11 SR 1913 - Powell Rd
- Map 12 SR 1915 - Kennon Rd
- Map 13 SR 1917 - Cannon Rd
- Map 14 SR 1920 - Maverick Rd
- Map 15 SR 1921 - Bailey Farm Rd
- Map 16 SR 1922 - Crownover Rd
- Map 17 SR 1926 - Chilton Rd
- Map 18 SR 1931 - Burton Rd
Resurface Bridge # 79
- Map 19 SR 1933 - Johnson Rd
- Map 20 SR 1934 - Nunley Rd
- Map 21 SR 1937 - Keesee Rd
- Map 22 SR 1940 - Aspen Rd
- Map 23 SR 1943 - Stone Rd
- Map 24 SR 1949 - Slaydon Rd
- Map 25 SR 1950 - Lark Rd
- Map 26 SR 1973 - River Ridge Rd
- Map 27 SR 1975 - Owl Rd
- Map 28 SR 1977 - Liveoak Rd
- Map 29 SR 1978 - Glass Rd
- Map 30 SR 1984 - Thompson Heights Rd
- Map 31 SR 2024 - Quaqua Creek Rd
- Map 32 SR 2026 - Spangler Farm Rd
- Map 33 SR 2027 - Dusty Ln
- Map 34 SR 2031 - Groff Rd
- Map 35 SR 2054 - Wyatt Lp
- Map 36 SR 2060 - Kent Rd
- Map 37 SR 2083 - Peace Rd
- Map 38 SR 2084 - Aberdeen Rd
- Map 39 SR 2085 - Mt Herman Church Rd
- Map 40 SR 2543 - Adams Rd
- Map 41 SR 2553 - Chicken Farm Rd
- Map 42 SR 2555 - Crossover Rd
- Map 43 SR 2556 - Mellow Rd
- Map 44 SR 2557 - Benton Rd
NO Pavement on Bridge # 156
- Map 45 SR 2560 - Ruffin Rd
- Map 46 SR 2562 - Playground Rd
- Map 47 SR 2563 - Ruffin School Rd
- Map 48 SR 2566 - Longbranch Rd
- Map 49 SR 2652 - Palm Rd
- Map 50 SR 2702 - Broadleaf Rd
- Map 51 SR 2708 - Service Rd
- Map 52 SR 2712 - Teaberry Lp
- Map 53 SR 2713 - Castle Dr
- Map 54 SR 2714 - Imperial Rd
- Map 55 SR 1380 - Bradley Rd
- Map 56 SR 1371 - Rockwell Dr

**CASWELL
ROCKINGHAM
COUNTY
NORTH CAROLINA**

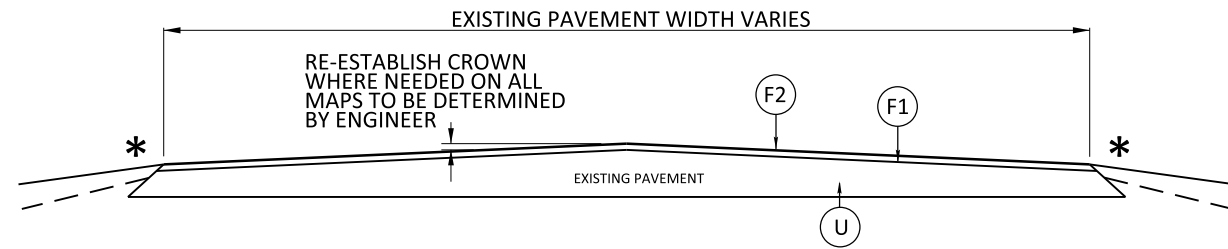

*** NOTE:**
THE SURFACE TO BE TREATED SHALL BE CLEANED TO THE SATISFACTION OF THE INSPECTOR PRIOR TO STARTING ON EACH MAP

TYPICAL SECTION NO. 1

Map 1	SR 1900 - Chandler Mill Rd Resurface Bridge #254	Map 18	SR 1931 - Burton Rd Resurface Bridge #79	Map 39	SR 2085 - Mt Herman Church Rd
Map 2	SR 1901 - Spring Water Rd	Map 19	SR 1933 - Johnson Rd	Map 40	SR 2543 - Adams Rd
Map 3	SR 1902 - Dibrell Rd NO Pavement on Bridge #106, Bridge to be replaced Tie down the AST Retreatment at the project limits and skip the length of the project.	Map 20	SR 1934 - Nunley Rd	Map 41	SR 2553 - Chicken Farm Rd
Map 4	SR 1903 - Sigmon Rd	Map 21	SR 1937 - Keesee Rd	Map 42	SR 2555 - Crossover Rd
Map 5	SR 1904 - Bradley Rd	Map 22	SR 1940 - Aspen Rd	Map 43	SR 2556 - Mellow Rd
Map 6	SR 1906 - Bark Rd	Map 23	SR 1943 - Stone Rd	Map 44	SR 2557 - Benton Rd NO Pavement on Bridge # 156
Map 7	SR 1908 - Lillard Rd Resurface Bridge #101	Map 24	SR 1949 - Slaydon Rd	Map 45	SR 2560 - Ruffin Rd
Map 8	SR 1910 - Dickerson Rd	Map 25	SR 1950 - Lark Rd	Map 46	SR 2562 - Playground Rd
Map 9	SR 1911 - Newton Rd	Map 26	SR 1973 - River Ridge Rd	Map 47	SR 2563 - Ruffin School Rd
Map 10	SR 1912 - Stephens Rd	Map 27	SR 1975 - Owl Rd	Map 48	SR 2566 - Longbranch Rd
Map 11	SR 1913 - Powell Rd	Map 28	SR 1977 - Liveoak Rd	Map 49	SR 2652 - Palm Rd
Map 12	SR 1915 - Kennon Rd	Map 29	SR 1978 - Glass Rd	Map 50	SR 2702 - Broadleaf Rd
Map 13	SR 1917 - Cannon Rd	Map 30	SR 1984 - Thompson Heights Rd	Map 51	SR 2708 - Service Rd
Map 14	SR 1920 - Maverick Rd	Map 31	SR 2024 - Quaqua Creek Rd	Map 52	SR 2712 - Teaberry Lp
Map 15	SR 1921 - Bailey Farm Rd	Map 32	SR 2026 - Spangler Farm Rd	Map 53	SR 2713 - Castle Dr
Map 16	SR 1922 - Crownover Rd	Map 33	SR 2027 - Dusty Ln	Map 54	SR 2714 - Castle Dr
Map 17	SR 1926 - Chilton Rd	Map 34	SR 2031 - Groff Rd	Map 55	SR 1380 - Myrtle Rd
		Map 35	SR 2054 - Wyatt Lp	Map 56	SR 1371 - Rockwell Dr
		Map 36	SR 2060 - Kent Rd		
		Map 37	SR 2083 - Peace Rd		
		Map 38	SR 2084 - Aberdeen Rd		

NOTE: NON-SYSTEM = (CITY STREET, PRIVATE DRIVE, SCHOOL BUS DRIVE)

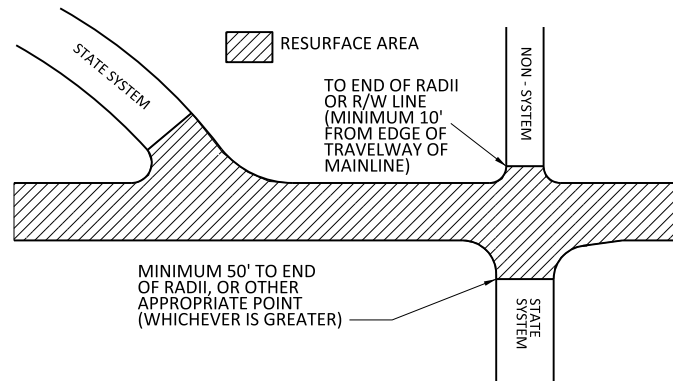

PAVING DETAIL 1
MAIN LINE IS BEING RESURFACED

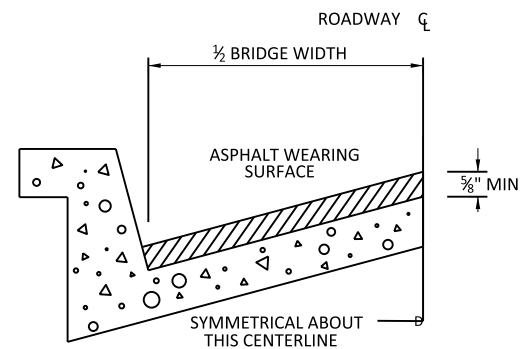

BRIDGE HALF TYPICAL SECTION

FOR BRIDGES WITH FLOOR DRAINS, CARE SHALL BE EXERCISED IN PLACING THE WEARING SURFACE AROUND FLOOR DRAINS SO AS NOT TO HINDER EFFECTIVE DRAINAGE. ALL DRAINS SHALL BE LEFT OPEN. THE PROPOSED WEARING SURFACE SHALL VARY IN THICKNESS AS NECESSARY TO PROVIDE A SMOOTH RIDING SURFACE. A THICKNESS OF NOT LESS THAN 3/8" SHALL BE PROVIDED. THE MAXIMUM THICKNESS SHALL PREFERABLY BE 1-1/2" UNLESS IT IS IMPRACTICAL TO PROVIDE A SMOOTH RIDING SURFACE OTHERWISE.

NOTES
ALL UNPAVED S.R. ROUTES TO BE SURFACED 50' FROM EDGE OF PAVEMENT OF MAIN PROJECT.
ALL PAVED S.R. ROUTES TO BE RESURFACED TO END OF RADII, OR AS DIRECTED BY THE ENGINEER. EDGES, PAVEMENT WIDENING, INTERSECTIONS AND BRIDGE FLARES ARE INCLUDED IN THE SUMMARY OF QUANTITIES. BRIDGES TO BE RESURFACED AT LOCATIONS AND DEPTH AS DIRECTED BY THE ENGINEER.

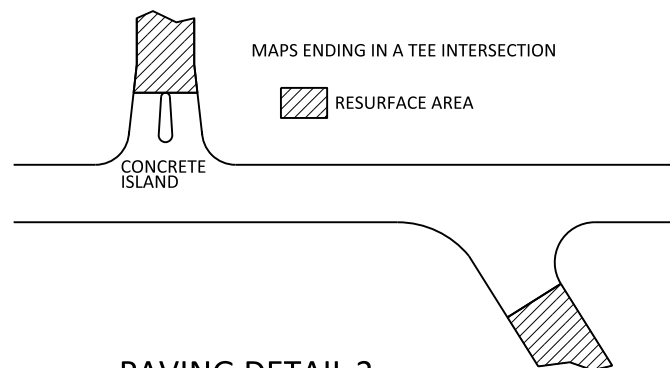

PAVING DETAIL 2
MAIN LINE NOT BEING RESURFACED

PAVEMENT SCHEDULE	
F1	PROPOSED ASPHALT SURFACE TREATMENT, DOUBLE SEAL
F2	PROPOSED FOG SEAL
U	EXISTING PAVEMENT

SIGNING FOR ASPHALT SURFACE TREATMENT

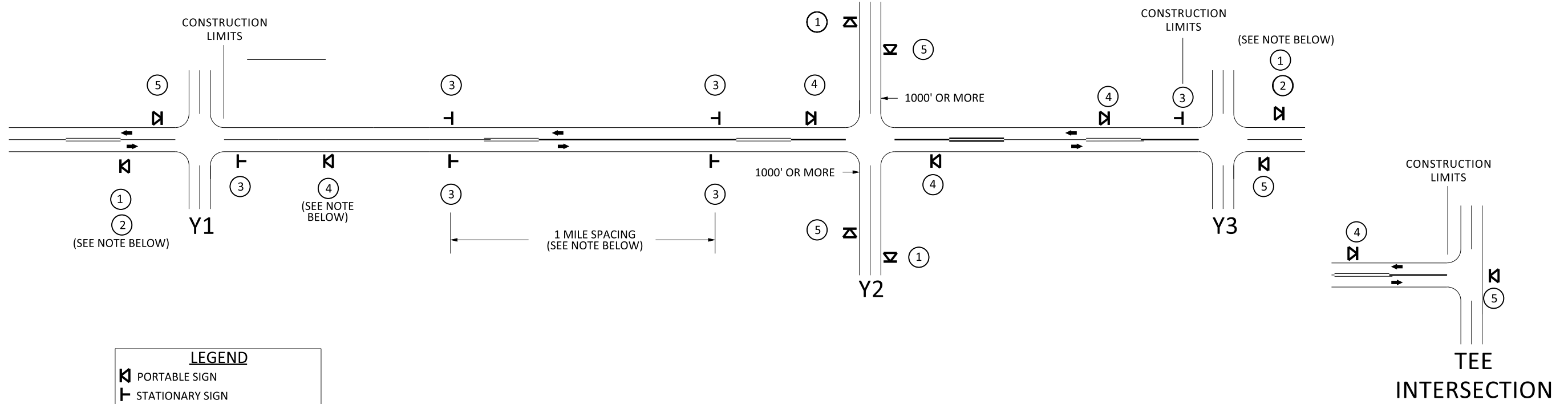

LEGEND	
K	PORTABLE SIGN
T	STATIONARY SIGN
←	DIRECTION OF TRAFFIC FLOW

MAINLINE (-L-) SIGNING

-Y- LINE SIGNING

SIGNING NOTES AND PLACEMENT PER DIRECTION	<p>① </p> <p>② </p> <p>PLACE 1000' PRIOR TO BEGINNING OF CONSTRUCTION LIMITS. ONLY USED ON -Y- LINES IF RESURFACING LIMITS EXTEND 1000' ALONG -Y- LINE.</p> <p>#2 SIGN ONLY USED WHEN RESURFACING LIMITS ARE 2 OR MORE MILES IN LENGTH. ROUND UP TO NEXT WHOLE NUMBER.(NO FRACTIONAL OR DECIMAL NUMBERS)</p>
	<p>③ </p> <p></p> <p>- ALTERNATE THE FOLLOWING TWO SIGNS:</p> <p>- STARTING WITH "LOOSE GRAVEL" (WB-7) FOLLOWED BY "UNMARKED PAVEMENT".</p> <p>- PLACE INITIALLY AT THE CONSTRUCTION LIMITS AND SPACED 1 MILE APART THEREAFTER.</p> <p>- AT TEE INTERSECTIONS INSTALL INITIALLY 0.5 MILES FROM INTERSECTION AND SPACE 1 MILE APART THEREAFTER.</p>
	<p>④ </p> <p>THESE ARE FOR -Y- LINES THAT ARE "THROUGH" ROADWAYS. DEAD END AND SUBDIVISION ROADS ARE NOT "THROUGH" ROADWAYS. INSTALL 500' +/- FROM EACH -Y- LINE APPROACH AS SHOWN ABOVE. FOR MULTIPLE -Y- LINES THAT ARE SEPARATED BY 0.25 MILES OR LESS, TREAT AS A SINGLE UNIT AND INSTALL WITHIN 500' OF EACH APPROACH. A MAXIMUM OF 2 SIGN SETS PER MILE. DO NOT INSTALL WHEN -Y- LINES ARE WITHIN 0.5 MILES FROM "END ROAD WORK" SIGN.</p>
	<p>⑤ </p> <p>PLACE 500' FOLLOWING THE END OF CONSTRUCTION LIMITS.</p>

NO REQUIRED STATIONARY SIGNING FOR THE FOLLOWING -Y- LINE CONDITIONS:

- LESS THAN 1000' OF RESURFACING ALONG -Y- LINE
- SUBDIVISION ROADS
- DEAD END ROADS

WHEN PAVING/CONSTRUCTION ACTIVITIES PROCEED ACROSS AN UNSIGNED -Y- LINE, ADVANCE WARNING PORTABLE SIGNS SHALL BE USED ALONG THE -Y- LINE AS SHOWN BELOW. REMOVE UPON COMPLETION OF WORK.

PLACED 500' IN ADVANCE OF FLAGGER.

PLACED 250' IN ADVANCE OF FLAGGER.

THE ABOVE SIGNS ARE ALL THAT ARE REQUIRED FOR A CONTRACTOR TO BEGIN A RESURFACING CONTRACT. ANY ADDITIONAL SIGNS REQUESTED BY NCDOT DIVISIONS SHALL BE INSTALLED WITHIN 7 BUSINESS DAYS OF THE START OF CONTRACT WORK.

MAPS LESS THAN 2 MILES

FOR AST RESURFACING MAPS WITH CONSTRUCTION LIMITS LESS THAN 2 MILES IN LENGTH, USE A STATIONARY "LOOSE GRAVEL" SIGN AT THE BEGINNING CONSTRUCTION LIMIT FOLLOWED BY AN "UNMARKED PAVEMENT" SIGN MIDWAY THROUGH AND AN "END ROAD WORK" SIGN AT THE END CONSTRUCTION LIMIT.

**RESURFACING
ADVANCE WARNING SIGNS
FOR
RURAL AND SUBURBAN
2 LANE ROADWAYS**

2022 Rockingham and Caswell County AST													Project No.		Sheet No.
													2022CPT.07.20.20172	4	
													2022CPT.07.20.20172		
Map #	SR # Name	Description	Length	Width	1803500000-E	1820000000-E	1838000000-E	1838500000-N	4413000000-E	4457000000-N	4685000000-E	4890000000-E	4890000000-E	4890000000-E	
					ASPHALT SURFACE TREATMENT, DOUBLE SEAL	ASPHALT SURFACE TREATMENT, FOG SEAL	EMULSION FOR ASPHALT SURFACE TREATMENT	VACUUM TRUCK	WORK ZONE ADVANCE/GENERAL WARNING SIGNING	TEMPORARY TRAFFIC CONTROL	4" X 90 M WHITE THERMO	6" HOT SPRAY THERMO (WHITE)	4" HOT SPRAY THERMO (WHITE)	4" HOT SPRAY THERMO (YELLOW)	
					SY	SY	GAL	WK	SF	LS	LF	LF	LF	LF	
Map 1	SR 1900 - Chandler Mill Rd	From NC 700 TO CASWELL CO	1.69	21.2	20,964	20,964	11,530	4	189	1		46	17,800	17,800	
Map 2	SR 1901 - Spring Water Rd	From NC 700 TO DEAD END	0.44	18.5	4,829	4,829	635		49						
Map 3	SR 1902 - Dibrell Rd	From SR 2708 - Service Rd TO NC 700	3.52	20	41,538	41,538	22,999		394				37,134	37,134	
Map 4	SR 1903 - Sigmon Rd	From SR 1904 - Bradley Rd TO DEAD END	0.49	17.5	5,167	5,167	2,903		56						
Map 5	SR 1904 - Bradley Rd	From CASWELL CO TO DEAD END	0.45	18	4,972	4,972	2,857		51						
Map 6	SR 1906 - Bark Rd	From SR 1767 - Mayfield Rd TO END MAINT	0.52	21	6,549	6,549	3,687		59						
Map 7	SR 1908 - Lillard Rd	From NC 700 TO SR 2023 - Guerrant Springs Rd	2.02	19.6	23,215	23,215	12,768		227				21,320	21,320	
Map 8	SR 1910 - Dickerson Rd	From NC 700 TO SR 2023 - Guerrant Springs Rd	1.51	19	16,857	16,857	9,271		170				15,970	15,970	
Map 9	SR 1911 - Newton Rd	From NC 700 TO DEAD END	0.55	19.6	6,467	6,467	3,610		63						
Map 10	SR 1912 - Stephens Rd	From NC 700 TO SR 2023 - Guerrant Springs Rd	1.48	18.5	16,085	16,085	8,847		166				15,650	15,650	
Map 11	SR 1913 - Powell Rd	From NC 700 TO DEAD END	0.38	17.5	4,000	4,000	2,261		43						
Map 12	SR 1915 - Kennon Rd	From SR 1914 - Triangle Station Rd TO DEAD END	0.79	18	8,447	8,447	4,699		89						
Map 13	SR 1917 - Cannon Rd	From SR 2023 - Guerrant Springs Rd TO DEAD END	0.83	20.5	10,076	10,076	5,603		93						
Map 14	SR 1920 - Maverick Rd	From SR 2023 - Guerrant Springs Rd TO END MAINT	1.00	20	11,944	11,944	6,716		112			18	10,510	10,510	
Map 15	SR 1921 - Bailey Farm Rd	From SR 1920 - Maverick Rd TO END PVMT	0.05	19.5	531	531	292		6						
Map 16	SR 1922 - Crownover Rd	From SR 2023 - Guerrant Springs Rd TO END PVMT	0.23	18	2,545	2,545	1,469		26						
Map 17	SR 1926 - Chilton Rd	From SR 1925 - Worsham Mill Rd TO END MAINT	0.53	20	6,278	6,278	814		59						
Map 18	SR 1931 - Burton Rd	From BEG PVMT TO SR 1929 - Estes Rd	0.89	19	10,389	10,389	5,982		100				9,380	9,380	
Map 19	SR 1933 - Johnson Rd	From US 29 BUS TO DEAD END	0.72	18.5	8,107	8,107	4,593		82						
Map 20	SR 1934 - Nunley Rd	From SR 1933 - Johnson Rd TO DEAD END	0.28	18.5	3,203	3,203	1,844		32						
Map 21	SR 1937 - Keesee Rd	From US 29 BUS TO DEAD END	0.64	20.5	7,794	7,794	4,332		72						
Map 22	SR 1940 - Aspen Rd	From SR 1914 - Triangle Station Rd/Oregon Hill Rd TO SR 1941 - Crutchfield Rd	0.82	20	9,856	9,856	5,549		92				8,660	8,660	
Map 23	SR 1943 - Stone Rd	From SR 1941 - Crutchfield Rd TO SR 1914 - Triangle Station Rd/Oregon Hill Rd	1.11	20.5	13,601	13,601	7,619		125			36	11,720	11,720	
Map 24	SR 1949 - Slaydon Rd	From NC 700 TO DEAD END	0.18	19.5	2,210	2,210	1,269		21						
Map 25	SR 1950 - Lark Rd	From SR 1951 - Quesinberry Rd TO DEAD END	0.21	20	2,633	2,633	1,522		24						
Map 26	SR 1973 - River Ridge Rd	From SR 1974 - Town Creek Rd TO DEAD END	0.78	18.5	8,607	8,607	4,787		88						
Map 27	SR 1975 - Owl Rd	From SR 1951 - Quesinberry Rd TO END MAINT	0.27	18.5	2,878	2,878	1,583		30						
Map 28	SR 1977 - Liveoak Rd	From NC 14 TO DEAD END	1.08	18.5	12,126	12,126	6,883		122			12	11,420	11,420	
Map 29	SR 1978 - Glass Rd	From SR 2037 - Harrison Crossroad Lp TO DEAD END	0.94	18.6	10,379	10,379	5,762		106						
Map 30	SR 1984 - Thompson Heights Rd	From SR 1982 - Wolf Island Rd TO DEAD END	0.21	18	2,180	2,180	1,199		24						
Map 31	SR 2024 - Quaqua Creek Rd	From SR 1929 - Estes Rd TO DEAD END	0.48	18.5	5,307	5,307	2,983		54						
Map 32	SR 2026 - Spangler Farm Rd	From NC 700 TO END MAINT	0.11	18	1,297	1,297	767		13						
Map 33	SR 2027 - Dusty Ln	From NC 700 TO DEAD END	0.23	18	2,547	2,547	1,454		26						
Map 34	SR 2031 - Groff Rd	From SR 2037 - Harrison Crossroad Lp TO DEAD END	0.09	17.5	875	875	481		10						
Map 35	SR 2054 - Wyatt Lp	From SR 1980 - Mt Carmel Church Rd TO SR 1980 - Mt Carmel Church Rd	0.25	18	2,650	2,650	1,458		29						
Map 36	SR 2060 - Kent Rd	From SR 1943 - Stone Rd TO DEAD END	0.16	16.8	1,587	1,587	873		19						
Map 37	SR 2083 - Peace Rd	From SR 1925 - Worsham Mill Rd TO DEAD END	0.23	19.5	2,600	2,600	1,430		26						
Map 38	SR 2084 - Aberdeen Rd	From SR 1925 - Worsham Mill Rd TO DEAD END	0.26	20	3,056	3,056	1,681		30						
Map 39	SR 2085 - Mt Herman Church Rd	From SR 1767 - Mayfield Rd TO DEAD END	0.45	19.5	5,175	5,175	2,892		50						
Map 40	SR 2543 - Adams Rd	From US 158 TO END MAINT	0.68	20	8,153	8,153	4,568		77						
Map 41	SR 2553 - Chicken Farm Rd	From SR 2552 - Narrow Gauge Rd TO DEAD END	0.25	20	3,042	3,042	418		29						
Map 42	SR 2555 - Crossover Rd	From US 29 BUS TO DEAD END	0.49	19.5	5,789	5,789	3,269		56						
Map 43	SR 2556 - Mellow Rd	From US 29 BUS TO SR 2557 - Benton Rd	0.03	19	317	317	174		4						
Map 44	SR 2557 - Benton Rd	From BEG PVMT TO DEAD END	0.90	20	10,976	10,976	6,263		101						
Map 45	SR 2560 - Ruffin Rd	From SR 2561 - Old US 29 TO PVMT CHG	0.38	18	4,126	4,126	2,355		43			14	3,970	3,970	
Map 46	SR 2562 - Playground Rd	From SR 2560 - Ruffin Rd TO SR 2563 - Ruffin School Rd	0.07	18	750	750	413		8						
Map 47	SR 2563 - Ruffin School Rd	From SR 2560 - Ruffin Rd TO END MAINT	0.17	17.5	1,951	1,951	1,211		19						
Map 48	SR 2566 - Longbranch Rd	From SR 2565 - Lick Fork Creek Rd TO DEAD END	1.20	19	13,686	13,686	7,711		135			22	12,650	12,650	
Map 49	SR 2652 - Palm Rd	From SR 2566 - Longbranch Rd TO END PVMT	0.24	18	2,661	2,661	1,525		28						
Map 50	SR 2702 - Broadleaf Rd	From NC 14 TO SR 1977 - Liveoak Rd	0.11	20	1,333	1,333	733		13				1,200	1,200	
Map 51	SR 2708 - Service Rd	From SR 1767 - Mayfield Rd TO CASWELL CO	1.77	24	26,468	26,468	15,416		199			86	18,680	18,680	
Map 52	SR 2712 - Teaberry Lp	From SR 1951 - Quesinberry Rd TO SR 1951 - Quesinberry Rd	0.16	17	1,558	1,558	857		18						
Map 53	SR 2713 - Castle Dr	From SR 1900 - Chandler Mill Rd TO DEAD END	0.38	18	4,147	4,147	2,334		43						
Map 54	SR 2714 - Imperial Rd	From SR 1900 - Chandler Mill Rd TO DEAD END	0.16	20	2,044	2,044	1,198		19						
Rockingham County TOTAL FOR PROJECT NO. 2022CPT.07.20.20792			33.85	miles	396,520	396,520	216,350	4	3,819	1		234	196,064	196,064	
Map 55	SR 1380 - Bradley Rd	From SR 1343 - Chandler's Mill Rd TO Rockingham Co. Line	0.08	18	950	950	523		10	1					
Map 56	SR 1371 - Rockwell Dr	From Rockingham Co. Line TO SR 1343 - Chandler's Mill Rd	0.31	24	5,485	5,485	3,017		35				3,230	3,230	
Caswell County TOTAL FOR PROJECT NO. 2022CPT.07.20.20172			0.39	miles	6,435	6,435	3,540		45	1			3,230	3,230	
GRAND TOTAL FOR PROJECT NO. 2022CPT.07.20.20792 2022CPT.07.20.20172			34.23	miles	402,955	402,955	219,890	4	3,864	2		234	199,294	199,294	